

Twin Stacker - transporting and lifting two pallets at the same time

Utilize space and save money! The Twin Stacker can transport and stack two pallets at the same time and can operate in very confined areas, e.g. in trucks and shopping and storage areas. The Twin Stacker has small dimensions, very low own weight and is very maneuverable!

A unique patented system "locks" mast and propulsion unit when lifting more than 900mm. The stacker is fully stable and safe, also when lifting. The Twin Stacker is very maneuverable also on uneven floors.

Twin Stacker has an elegant design with rounded corners and makes no damage to surroundings, pallets and goods. The design puts focus on the safety and ergonomic working conditions of the user. As an example the ergonomically correct handle ensures the user a relaxed hold.



Technical Specifications

Capacity

- In total 4000 lbs
- On the lowest forks: Up to 4000 lbs
- On the upper forks: Up to 1760 lbs

Perfect in confined areas

- Length behind the forks of only 25.75"
- Tight turning angle of 210°
- Narrower than the width of a EUR pallet - it can operate in aisles as narrow as a pallet width

High performance with AC technology

- Very maneuverable on uneven floors
- Unique patented system ensures stability when lifting more than 35.5"
- Easy maintenance and setting of e.g. driving speed and acceleration
- Long operation time per charge
- Motor brake - optimum safety



Low own weight means better utilization of the capacity of the truck tail-gate.



By utilizing the space better in the trucks, the number of transport tours can be reduced.



New and unique patented system ensures stability and safety when lifting.



The low overall height gives optimum view conditions.



High free height makes it easy to cross edges and operate on uneven floors.

Product (measured in inch)		TS 1801
Capacity (lbs) upper forks	Q ₁	1760
Capacity (lbs) lowest forks	Q	4000 - Q ₁
Lifting height upper forks	h ₃	69
Fork length	l	45
Overall height	h ₁	53.5/58.25 (lowest forks lowered/raised)
Overall width	b ₁	24
Fork span	b ₅	22
Fork width	e	6.5
Length without forks	l ₂	25.75
Overall length	l ₁	71
Overall height	h ₄	86
Lowered height, forks	h ₁₃	3.25/3.5 (lowest forks/upper forks)
Lifting height lowest forks	h ₅	8
Wheelbase	y	57.5
Load centre	c	l/2
Turning angle of the wheels		210°
Gangway	A _{st}	92*
Run-in length	l _x	44.25
Turning radius	W _a	64.4
Driving motor		24V 1.2 kW speed control electronically variable
Driving speed with/without load		Below 28.75/33.5** inch. lift: 5/6 km/h, over 28.75/33.5** inch lift: 3/4 km/h
Pump motor upper forks		24V 1.2 kW
Lifting speed with/without load upper forks		70/120 mm/s
Lowering speed with/without load upper forks		120/70 mm/s
Pump motor lowest forks		24V 1.2 kW
Lifting speed with/without load lowest forks		35/50 mm/s
Lowering speed with/without load lowest forks		115/40 mm/s
Weight in lbs without battery		1025

* Tests show that 73" are enough.

** lowest forks lowered/raised

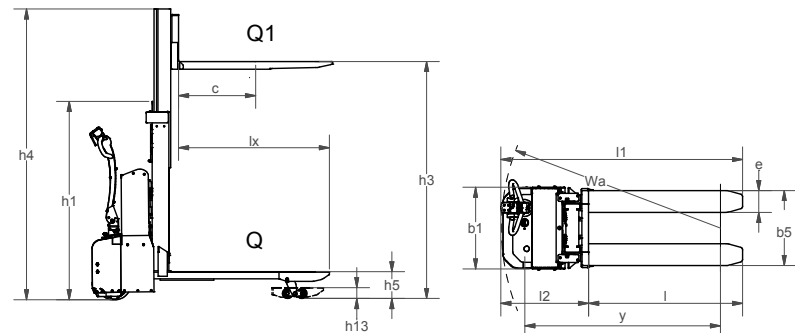

We also offer tailor-made solutions.

Please ask for further information or visit www.interthor.com