

Stainless Thork-Lift - hygiene at working height

Focus on optimum hygiene - the stainless Thork-Lift is developed for the use in environments with high hygiene demands. This is done in close cooperation with customers in industries where the trucks are exposed to an aggressive environment and thorough cleaning. With a stainless Thork-Lift the risk of bacterial contamination is minimized.

High flexibility and efficiency - one product can transport and lift a pallet to the right working height.

The design prevents industrial injuries and strain on the user - focus is put on safety and ergonomics.

High quality is ensured through an extended test program and in cooperation with experts in Health and Safety.



Technical Specifications

Loads of 3300 lbs. can be transported and lifted up to 18.5 inches with the highlifter. From 18.5 inches the lifting capacity is 2200 lbs.

Easy to clean and optimum resistance
 • acid-resistant and electric polished fork chassis (AISI 316L)

TL-M RF-PLUS: Stainless handle, legs and pump piston.

TL-E RF-PLUS: IP54. Stainless battery cover, legs, handle and cylinder housing.

TL-M RF-SEMI: Stainless handle, pump piston, axles and wheel holder. All other parts have a polymer plastic coating or are chromit-treated.

TL-E RF-SEMI: Stainless handle, axles and wheel holder. All other parts have a polymer plastic coating or are chromit-treated. Battery indicator extra painted.



Optimum safety through supporting feet at steering wheel, foot protection and central location of all control buttons on the handle.



Closed forks mean easy cleaning and few hiding places for bacteria.



The stainless Thork-Lift is available in electric and manual versions.

Product (measured in inch)	TL-M 1004 RF-PLUS TL-M 1004 RF-SEMI	TL-E 1004 RF-PLUS TL-E 1004 RF-SEMI
Capacity in lbs.	3300*	3300*
Lifting height	h_3 31.5	31.5
Fork length	l 47	47
Overall height	h_1 21.25	21.25
Fork span	b_5 21.25, 27	21.25, 27
Length without forks	l_2 13.5	17.55
Overall length	l_1 62.2	64.8
Overall height with handle	h_4 48	49
Lowered height	h_{13} 3.5	3.5
Fork width	e 6.5	6.5
Turning angle of the wheels	210°	180°
Gangway	A_{st} 72 (pallet: 47 x 31.5)	74.5 (pallet: 47 x 31.5)
Lifting speed with/without load		2'3.25" per sec.
Lowering speed normal/quick	0.5'/1.5" per pump	
Lowering speed	Without load 3.5" per sec.	With/without load: 2.75"/2" per sec.
Pump motor		1,2 kW 12 V
Weight with 45" forks (without battery)	275 lbs.	291 lbs.

* The capacity changes from 3300 to 2200 lbs. at the lifting height 18.5".



RF-PLUS - for the food industry and the pharmaceutical industry with severe demands for hygiene and cleaning.

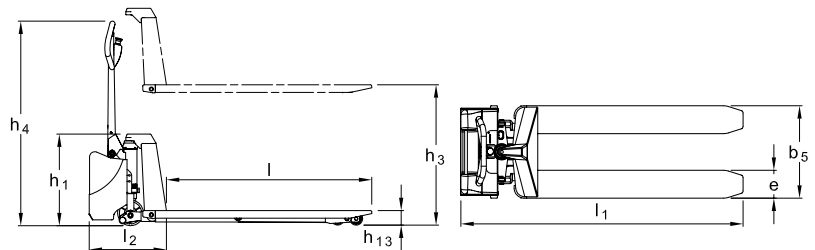

RF-SEMI - for the food industry in areas, where hygiene demands are not so high, but corrosion resistance important.



Ergonomic handle ensures the user a relaxed hold.



Remote control is available as optional extra (TL-E).



Watertight casing of the lifting motor (TL-E RF-PLUS).

We also offer tailor-made solutions.

Please ask for further information or visit www.interthor.com